

On Site Instructions for upgrading CT to CO controller

1. Unplug the unit
2. Unplug FCT and pH/ORP Probes and undo the Molex connector

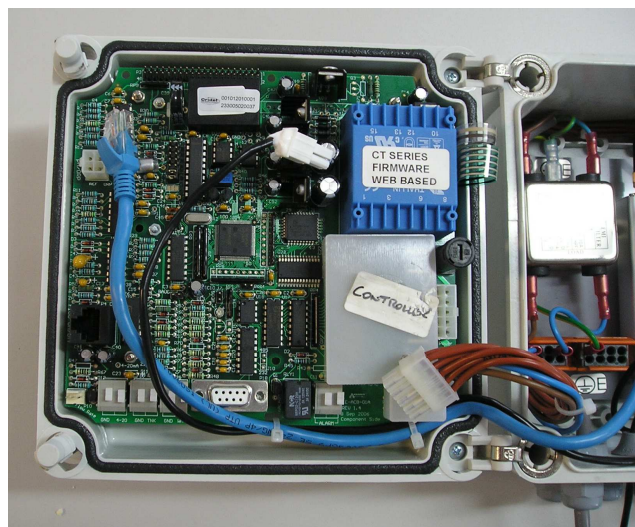

- Using Panel Hinge Tool remove front panel and control card from mounting box.

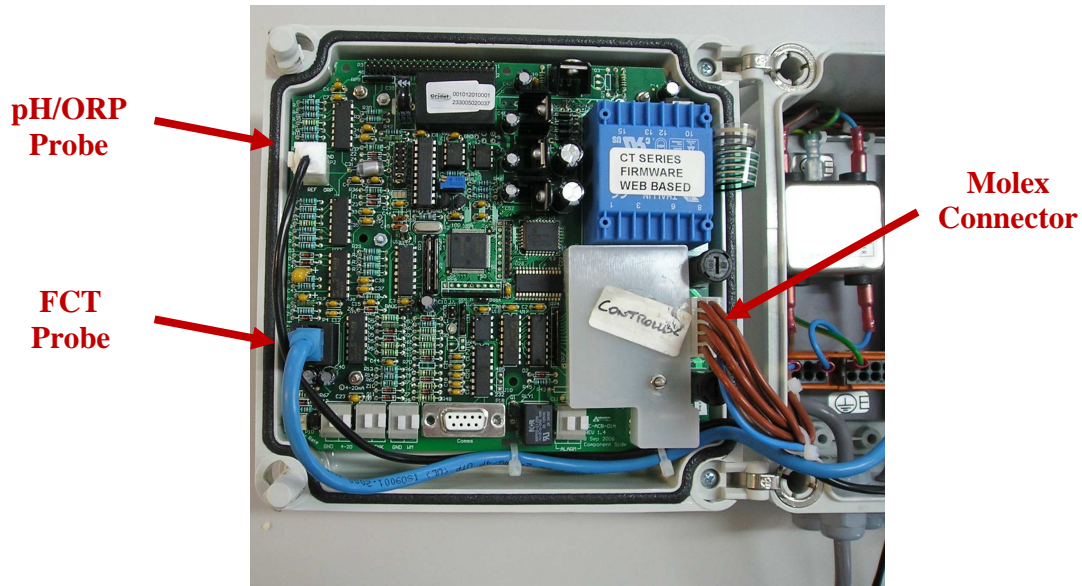
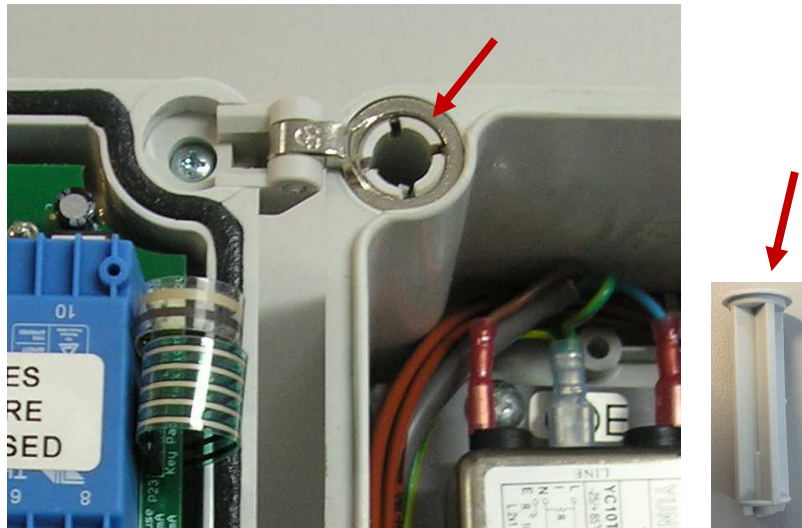

- Refit new control panel.
- Connect NEW MOLEX wiring harness to control card.
- Screw the terminal block to the base in the box and apply sticker.

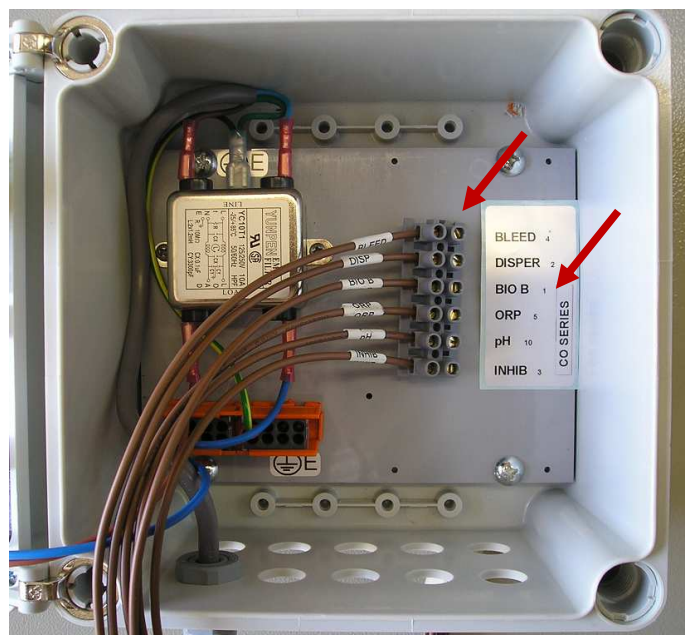

New White Molex Connector looking from top

5	ORP	10	PH
4	Bleed		Earth
3	Inhib		Neutral
2	Disp		Active
1	Bio-B		Active

7. Disconnect existing Active input lead from EMI filter (bottom left connection) and connect spade connector from new MOLEX connector.

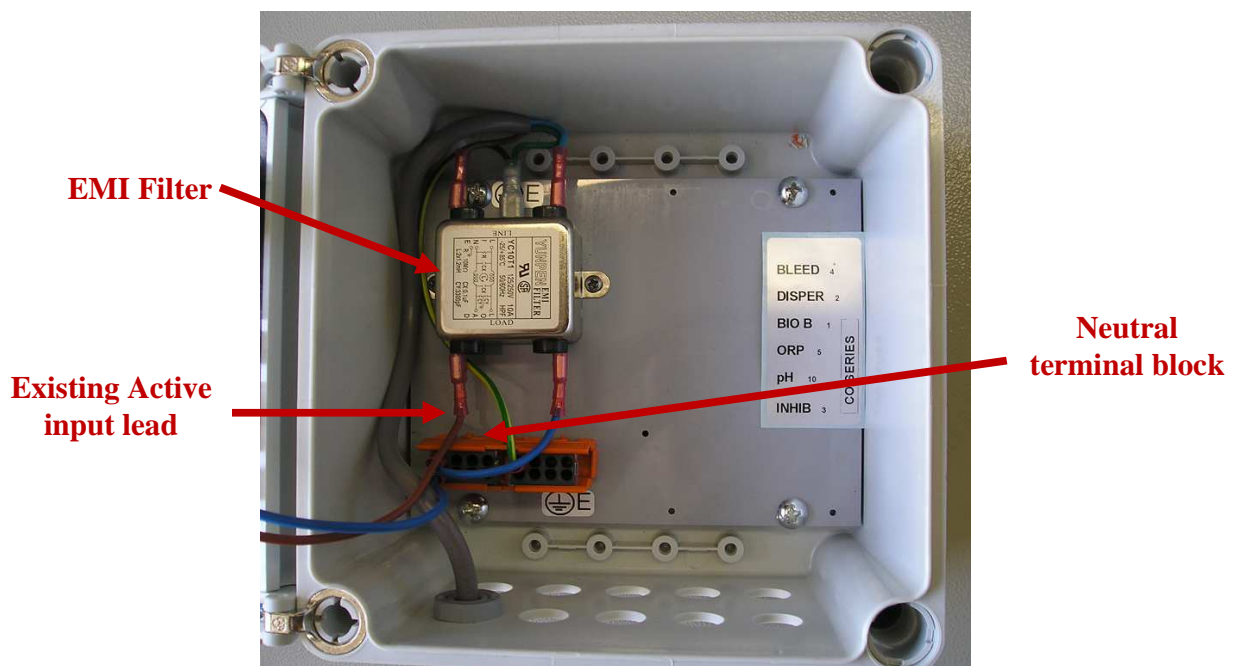

8. If there is sufficient space insert Neutral lead in to Main terminal block, cut and remove original Neutral input lead at MAIN terminal block. However if there is insufficient space cut original Neutral lead and connect to new Neutral lead using an approved electrical termination.
9. Reconnect any other probes / flow switches as required.
10. Reapply power and test card